

NEW HVAC EXCEEDS
CDC RECOMMENDATIONS

2350

WEST EL
CAMINO
MOUNTAIN
VIEW

FULLY
RENOVATED



113,964 sf AVAILABLE - NOW
Fully renovated

CHASE LYMAN ♦ 650.400.5700 ♦ clyman@sobrato.com

ROBERT TERSINI ♦ 408.691.3291 ♦ rtersini@sobrato.com

The
SOBRATO
Organization



2350

WEST EL CAMINO
MOUNTAIN
VIEW



01

BUILDING STATS



113,964 SF
Size



6
Floors



1999
Year Built



3 LEVELS
of secured
underground parking
(410 total spaces)



277/480
volt, 3-phase,
2000amps



3
passenger elevators
1 freight elevator



GRADE LEVEL
shipping/
receiving

2350

WEST EL CAMINO
MOUNTAIN VIEW



02

BUILDING
HIGHLIGHTS



10 MINUTE
walk to
Caltrain



VTA STOP
in front of
building



MIDWAY
between I-280
and US-101



WALKING
distance to
Whole Foods &
The Village @ San Antonio



AVAILABLE
Building
signage



NEWLY
renovated outdoor
amenity area
(over 12,000 sq ft)



AVAILABLE
Now

2350

WEST EL
CAMINO
MOUNTAIN
VIEW



EXIT



03

HEALTH &
WELLNESS



BRAND NEW HVAC

Far exceeds CDC recommendations

FILTER RATING

MERV 8

VENTILATION RATE

.085 CFM per ft.

CDC:

2350 W:

MERV 13

.15 CFM per ft.



RESTROOMS

TOUCHLESS

Entry
doors

TOUCHLESS

Fixtures

FLOORPLANS

LEVEL ONE

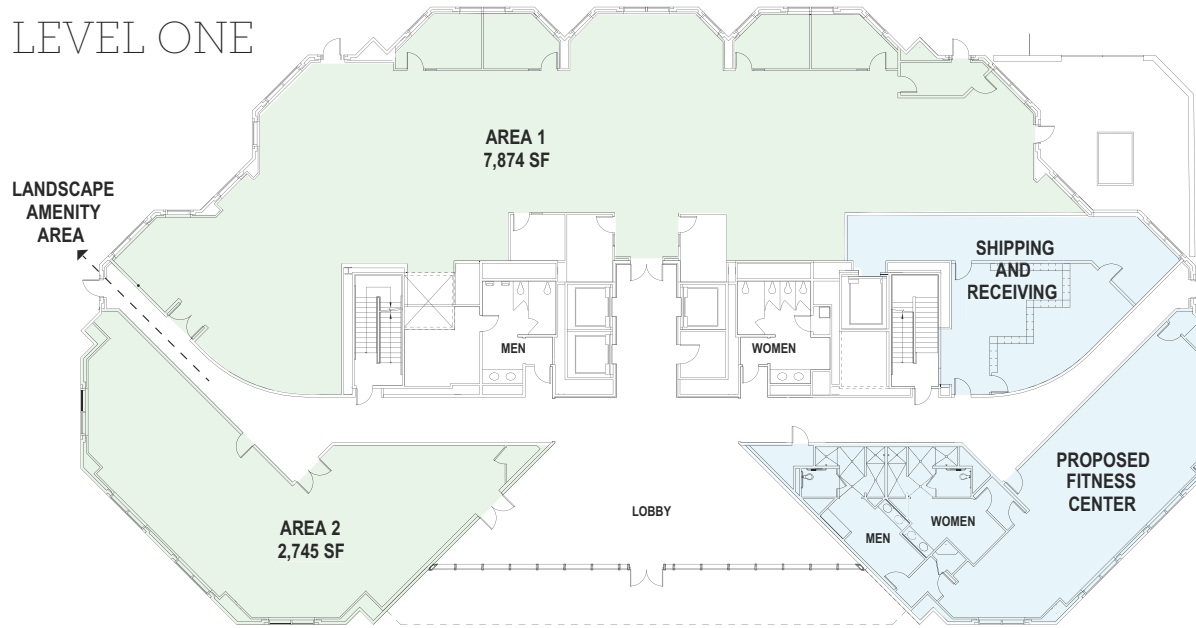

RENTABLE AREA

LEVEL ONE:	
AREA ONE:	7,874 SQ. FT.
AREA TWO:	2,745 SQ. FT.
LEVEL TWO:	21,407 SQ. FT.
LEVEL THREE:	22,431 SQ. FT.
LEVEL FOUR:	21,396 SQ. FT.
LEVEL FIVE:	19,048 SQ. FT.
LEVEL SIX:	19,063 SQ. FT.
<hr/>	
BUILDING TOTAL:	113,964 SQ. FT.

LEVEL SIX MARKET-READY



2350

WEST EL
CAMINO
MOUNTAIN
VIEW

05

OUTDOOR
WORK AREA



2350

WEST EL
CAMINO
MOUNTAIN
VIEW



CONTACTS

CHASE LYMAN

◆ 650.400.5700 ◆ clyman@sobrato.com ◆ CA RE License #00902221

ROBERT TERSINI

◆ 408.691.3291 ◆ rtersini@sobrato.com

The
SOBRATO
Organization